

BECKER Pre-sorting table

ICEline waste roller, washable

- ▶ for two waste/laundry bags (70 liters each)
- ▶ includes clip ring and bottom plate with standard rail on two sides
- ▶ made of chrome-nickel steel 1.4301 (AISI 304)
- ▶ suitable for machine washing
- ▶ 4 washable lockable polymer swivel castors Ø 125 mm with wall protectors

for table depths from 650 mm

- ▶ 2x ring 230 x 350 mm
- ▶ suitable for presorting table with safety device (back-to-back)
- ▶ 750 x 440 x 905 mm (W/D/H)

Article number: TE08237

for table depths from 800 mm

- ▶ 2x ring 350 x 350 mm
- ▶ suitable for a freestanding pre-sorting table
- ▶ 890 x 440 x 905 mm (W/D/H)

Article number: TE08227



The waste roller can be docked on either the right or left side of the pre-sorting table and moves along during height adjustment.

Accessories

The waste roller is equipped with a standard rail on two sides for attaching accessories.



Push handle

Article number: W1402 40160U



Glove dispenser

Article number: W1430 40035U

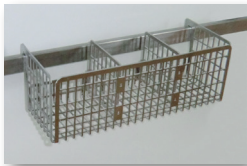

Grid basket

Article number: W1424 43043U



Holder for customers disposal box individually tailored to the on-site box

Article number: W1450 40011U

BECKER

WE SHINE WITH STEEL



Metallwarenfabrik
Walter H. Becker GmbH
Anzenkirchener Straße 4
84371 Triftern, Germany

Telefon +49 (0) 8562 9605-0
info@becker-triftern.de
www.becker-triftern.de



© Metallwarenfabrik Walter H. Becker GmbH · 10/2025 · We reserve the right to make modifications to designs and dimensions.

BECKER



PRE-SORTING TABLE

HOSPITAL STANDARD 2026

BECKER Pre-sorting table

The BECKER pre-sorting table is available in various designs and sizes, as well as with a wide range of accessories. It is adapted to the respective room size and individually manufactured according to customer requirements.

Pre-sorting table with table structure

- fixed or mobile
- height-adjustable or fixed working height
- two lower shelves
- Custom table design with integrated media supply
- LED lighting with 1000 lux on the tabletop
- left with light switch and power outlet (IP 44)
- additional sockets possible on the right
- different IT/monitor solutions
- Mounting plates for magnetic accessories
- dockable, washable waste roller
- ceiling connection
- 1.8 m power cable with power connection (patch cable on request); 230 V
- made of chrome-nickel steel material 1.4301, (AISI 304) surface grain 320
- Total height with superstructure 1950 mm



Pre-sorting table 2000 x 900 mm, mobile and height-adjustable, with the following features:

- custom colouring
- individual electrical and IT equipment
- Monitor mount PAM8001 + PAM8020 + PAM8025
- Scanner mount W1060 40002
- Holder with container 2x W1025 40041, 1x 120273 + 1x 120240
- MAGNES hooks 1x W1027 40001 + 1x W1027 40000

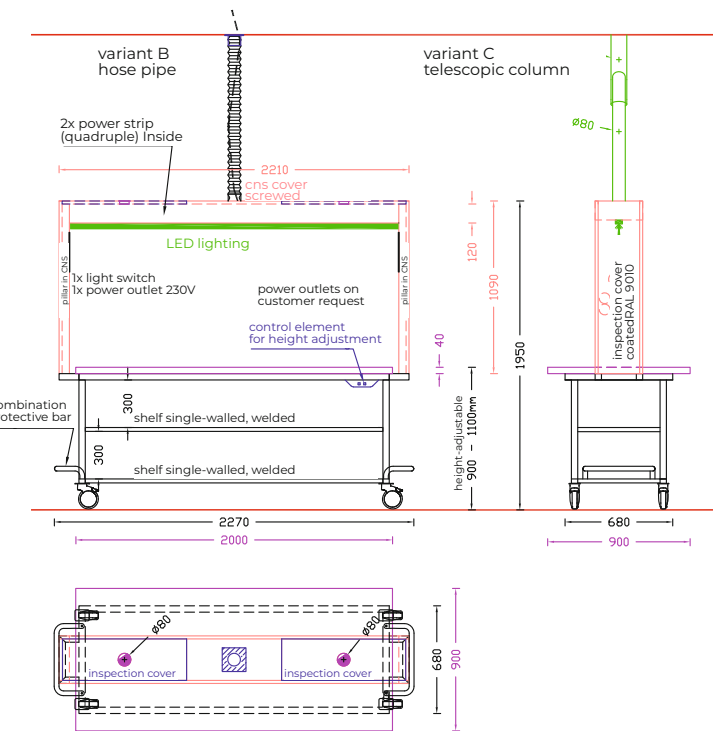

Ceiling connections

Variant A
Connection cable approx. 1.80 m with power plug and plug system on the table. (Included in article number PAM601)

Variant B
Flexible hose pipe, with ceiling connection

Article number: V05 510

Variant C
Telescopic column, adjusted to the room height. Only possible with fixed tables.

Article number: V05 500

Technical specifications

- The necessary supply connections must be provided on site.
- A force-fit connection to the suspended ceiling is required for ceiling attachment.
- Electrical connection 230 V.

BECKER Pre-sorting table



Pre-sorting table 1800 x 900 mm, mobile and height-adjustable with following features:

- Customized stainless steel MAG construction
- Electrical equipment BECKER Standard IP 44
- Monitor holder PAM8052

Description	Width	Depth 700 mm	Depth 800 mm	Depth 900 mm	Depth 1000 mm
		Article number	Article number	Article number	Article number
fixed and height-adjustable 900-1100 mm	1800 mm	PI 33 18 79 V0	PI 33 18 89 V0	PI 33 18 99 V0	PI 33 18 09 V0
	2000 mm	PI 33 20 79 V0	PI 33 20 89 V0	PI 33 20 99 V0	PI 33 20 09 V0
	2200 mm	PI 33 22 79 V0	PI 33 22 89 V0	PI 33 22 99 V0	PI 33 22 09 V0
mobile and height-adjustable 900-1100 mm	1800 mm	PIR 33 18 79 V0	PIR 33 18 89 V0	PIR 33 18 99 V0	PIR 33 18 09 V0
	2000 mm	PIR 33 20 79 V0	PIR 33 20 89 V0	PIR 33 20 99 V0	PIR 33 20 09 V0
	2200 mm	PIR 33 22 79 V0	PIR 33 22 89 V0	PIR 33 22 99 V0	PIR 33 22 09 V0
fixed 900 mm high	1800 mm	P 33 18 79 V0	P 33 18 89 V0	P 33 18 99 V0	P 33 18 09 V0
	2000 mm	P 33 20 79 V0	P 33 20 89 V0	P 33 20 99 V0	P 33 20 09 V0
	2200 mm	P 33 22 79 V0	P 33 22 89 V0	P 33 22 99 V0	P 33 22 09 V0
mobile 900 mm high	1800 mm	PR 33 18 79 V0	PR 33 18 89 V0	PR 33 18 99 V0	PR 33 18 09 V0
	2000 mm	PR 33 20 79 V0	PR 33 20 89 V0	PR 33 20 99 V0	PR 33 20 09 V0
	2200 mm	PR 33 22 79 V0	PR 33 22 89 V0	PR 33 22 99 V0	PR 33 22 09 V0

Structure: article number PAM601
Standard construction in powder-coated sheet steel, pure white RAL 9010 satin-gloss.
Custom colours available according to BECKER colour selection.



fixed and height-adjustable



fixed



mobile with 4 washable lockable polymer swivel castors Ø 125 mm



BECKER Pre-sorting table

Accessories



Accessory attachment can be retrofitted in different versions:

- a) MAGNES reception wall
- b) standard rail structure
- c) Hook rack attachment



Electrical outlets

- ▶ safety current (green)
- ▶ IP44

Ask us about customized equipment.



MAGNES magnifier lamp LED
with metal flex hose

- ▶ sensor button
- ▶ 6 dioptrs, 63 LEDs
- ▶ Lens Ø 72 mm
- ▶ cervical joint
- ▶ 750 mm arm length
- ▶ 100–240 V AC,
- ▶ 2.3 m power cable, CEE 7
- ▶ for magnetic mounting

Article number: W1080 70720



MAGNES holder

- ▶ for hanging up one container size 4 (without container)
- ▶ maximum load capacity 2.5 kg
- ▶ made of chrome-nickel steel for magnetic mounting

Article number: W1025 40041



Wire container

Size 4

- ▶ made of chrome-nickel steel

Article number: 120273



Container

Size 4

- ▶ made of plastic, blue

Article number: 120240



Monitor mounts

- ▶ Monitor arm with lift technology for monitor up to 49 inch (without monitor)
- ▶ includes keyboard and mouse tray 630 mm long (without keyboard)
- ▶ includes PC mount for clients 37–60 mm (without PC)
- ▶ tilt, extend and height adjustable
- ▶ Load capacity max. 14 kg

Article number: PAM8001 + PAM8020 + PAM8025



- ▶ Monitor wall holder for flat-screen monitors 19-43 inches (without monitor)
- ▶ rotatable and tilttable
- ▶ Wall distance 58 - 302 mm
- ▶ Load capacity 15 kg

Article number: PAM8052



- ▶ Monitor wall holder for monitors 30-60 inches (without monitor)
- ▶ rotatable, tilttable, and swiveling
- ▶ height adjustable 510 mm
- ▶ Load capacity 15.9 - max. 31.8 kg

Article number: PAM8065



MAGNES scanner holder

- ▶ for hanging up one standard hand scanner (scanner not included)
- ▶ made of chrome-nickel steel for magnetic mounting
- ▶ 75 x 100 x 75 mm high

Article number: W1060 40002



MAGNES Keyboard touchpad

- ▶ disinfectable
- ▶ completely sealed for magnetic mounting

Article number: W1060 90001

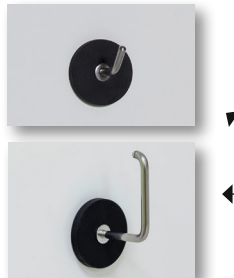

MAGNES hook

- ▶ Load capacity 8.5 kg for magnetic mounting

Article number: W1027 40000

Article number: W1027 40001